

CFVL49ACS

500 lbs [225 kg]

CFVL69ACS

750 lbs [340 kg]



C-FRAME/ VERTICAL LIFTERS 500 & 750

These Powr-Grip® vacuum lifters feature a unique design for moving materials into and out of upright cases.

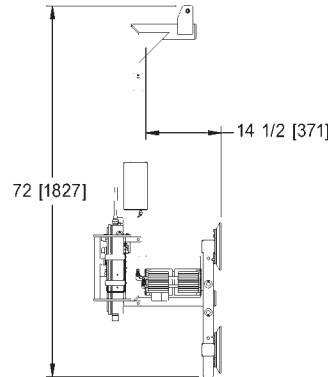
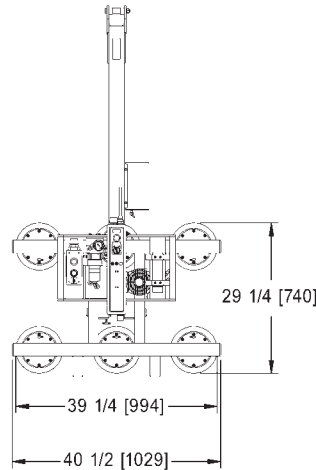

**THE ORIGINAL
& TRUSTED NAME
IN VACUUM LIFTING
EQUIPMENT**



908 West Main - P.O. Box 368
Laurel, Montana 59044 U.S.A.
406.628.8231 (phone)
406.628.8354 (fax)

800.548.7341
www.WPG.com



Products are manufactured under an
ISO 9001 quality management system

Wood's Powr-Grip products are sold
through authorized dealers.

	CFVL49ACS	CFVL69ACS
Standard Pad Spread	29¼" x 39¼" [740 x 994 mm]	29¼" x 39¼" [740 x 994 mm]
Number / Size of Pads	4 / 9" [23 cm] diameter	6 / 9" [23 cm] diameter
Load Capacity	500 lbs [225 kg]	750 lbs [340 kg]
Apply (approximately)	2 seconds	3 seconds
Release (approximately)	1 second	2 seconds
Standard Operating Power	120 volts AC, 50/60 hertz, 5 amps (Other voltages available)	
Load Movement	Upright to upright	
Standard Throat Depth	14½" [371 mm]	
Standard Features	Vacuum reserve tank Vacuum line filter Vacuum gauge Green lift light Movable control pendant Spring-mounted pads Industrial grade switches Twist-lock electrical plug Blow-off for quick release	
Available Options	Vacuum loss warning buzzer (EO3VLW) 12-Volt/DC vacuum back-up system (EO1DCB) Individual pad shutoffs (CM1COWB)	
Alternative Power Systems (Specifications may not be as listed above. Please contact us for more information.)	DC power system (CFVL49DCS or CFVL69DCS) Air (venturi) power system (CFVL49AIRS or CFVL69AIRS)	
Design Standards (See www.WPG.com for more information.)	ASME B30.20 - 2006 (BTH-1 Design Category "B", Service Class "O")	

Environmental conditions can affect product performance and longevity; consult the product instructions on
www.WPG.com or contact a Technical Sales Representative for more information.
Based on product information at time of publication.