

The highlifter - quality at working height

The highlifter can transport and lift a pallet to the right ergonomic working height, and is very gentle to surroundings, pallets and goods. The highlifter has an elegant design with rounded corners.

The design prevents industrial injuries and strain on the user - focus is put on safety and ergonomic working conditions of the user. As an example, the ergonomically correct shape of the handle ensures a relaxed hold for the user.

High quality is ensured through an extended test programme and in cooperation with experts in Health and Safety.



Technical Specifications

Loads of 1,500 kg can be transported and lifted up to 470 mm with the high-lifter. From 470 mm the lifting capacity is 1,000 kg.

Optimum user-friendliness

- low own weight
- central location of all control buttons
- ergonomic handle

Long operating life and low maintenance costs

- reliable cylinder construction
- strong construction
- use of quality materials

Optimum stability

- low overall height
- fork length of 1200 mm
- supporting feet at steering wheel
- tandem wheels on scissors legs



The tandem wheels have a brake effect and are not hostile to the floor.



Ergonomic handle ensures the user a relaxed hold.



Level control (optional extra) ensures a constant working height.



The manual highlifter needs very low power for the pump function and has foot protection and neutral position.



Optional extras: remote control, level control, brake, separate or built-in charger.

Product (measured in mm)	HL 1006					EHL 1004				
	1500*					1000				
Capacity in kg	1500*					1000				
Lifting height h_3	500	600	800	800	800	500	600	800	800	800
Fork length l	700	900	1200	1520	2000	700	900	1200	1520	2000
Overall height h_1	540					540				
Fork span b_5	480, 540, 680		540, 680			480, 540, 680		540, 680		
Length without forks l_2	356					451				
Overall length l_1	1056	1256	1556	1876	2356	1151	1351	1651	1971	2451
Overall height with handle h_4	1225					1195				
Lowered height h_{13}	85		90			85		90		
Fork width e	163					163				
Turning angle of the wheels	230°					180°				
Gangway A_{st}	1830 (pallet: 1200 x 800)					1890 (pallet: 1200 x 800)				
Lifting speed with/without load						0,05/0,08 m/s				
Lifting speed normal/quick	10/35 mm per pump									
Lowering speed	Without load 0,093 m/s					With / without load: 0,07/0,05 m/s				
Pump motor						0,9 kW 12 V				
Weight with 1200 mm forks (no battery)	95 kg					104 kg				

* The capacity changes from 1500 to 1000 kg at the lifting height 470 mm.

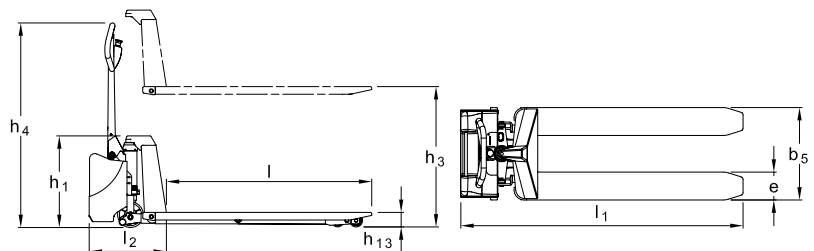

Can be marked with name/department.



Available as manual, electric, stainless and explosion proof.



Patented cylinder construction gives low overall height.

We also offer tailor-made solutions.

Please ask for further information or visit our website www.logitrans.com